

# Welcome to Cohen-Rosen House

## INNOVATIVE MEMORY CARE

Our innovative memory care residence at Cohen-Rosen House combines a nationally recognized design with a household model approach to help residents maintain a meaningful and enjoyable quality of life.

Cohen-Rosen House provides a safe, serene, and caring home for individuals living with Alzheimer's disease or other dementia-related disorders. Residents experience the benefits of a unique setting where private accommodations, creative programming, and personal solutions shape each day.

Each daily experience is designed to maintain important connections in life — family, faith and values, caregivers and neighbors, the natural environment, comfort, and security.



## COHEN-ROSEN HOUSE HIGHLIGHTS

- » Physician services available
- » On-site licensed nurse 24/7
- » Award-winning community design
- » LEED Silver certification
- » Individualized person-centered engagement
- » A full suite of services on campus including our top-ranked Post-Acute Care Center
- » Religious services and spiritual care are available to residents of all faiths



SCAN TO  
LEARN MORE

### COHEN-ROSEN HOUSE

# A Day Designed Around You

The homelike environment focuses on the needs and desires of the whole person: social, emotional, spiritual, physical and intellectual. Residents can enjoy the tranquil garden, visit with family in the light-filled great room or just relax on the couch with a good book.

Programs are individualized for each of our residents and a typical day might include:

#### MORNINGS

- » Gardening
- » Brain fitness
- » Creative arts
- » Scenic drives
- » Wellness exercises
- » Museum outings

#### AFTERNOONS

- » Art studio session with our Creative Engagement Coordinator
- » Violin recital
- » Bingo
- » Baking
- » Social gatherings
- » Piano performance

#### EVENINGS

- » Evening movie

#### AT YOUR LEISURE

- » Music room
- » Four seasons room
- » Quiet room
- » Garden courtyard
- » Computer/technology center
- » Kitchen

### DAILY MENU SAMPLE

— Certified Kosher Dining Options —

#### BREAKFAST MENU

- » Choice of juices, breads, and cereals
- » Oatmeal
- » Fruit
- » Scrambled eggs with vegetables

#### LUNCH MENU

- » BBQ beef sandwich
- » Sweet potato wedges
- » Green beans and carrots
- » Tuna fish salad plate
- » Chicken salad on croissant
- » Apple-cranberry crisp

#### DINNER MENU

- » Potato and mushroom soup
- » Roasted turkey with cranberry stuffing
- » Rice pilaf
- » Roasted butternut squash
- » Peach cobbler with pareve ice cream



## COHEN-ROSEN HOUSE

# A Place to Call Home

Cohen-Rosen House is a LEED (Leadership in Energy and Environmental Design) Silver certified building that features a private studio apartment for each of our residents with its own private bathroom and shower.

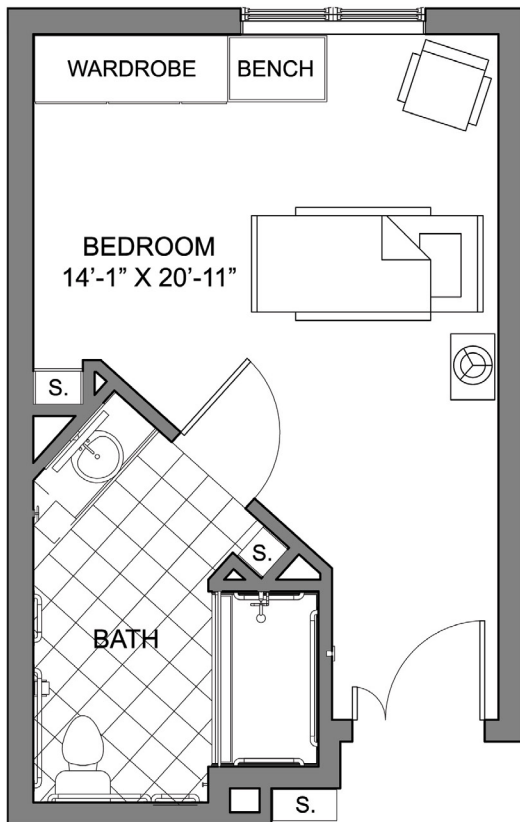

**PALISADE**  
1 bedroom / 1 bath



COHEN-ROSEN HOUSE

Apartment Rates

MONTHLY RATES

Palisade studio .....\$10,958\*

Service Levels

Your monthly fee will be based on your apartment and on the services you request or require, determined by a personalized assessment. A change in your service needs will prompt a reassessment and modification to your plan of care.

LEVEL I .....\$1,417

LEVEL II .....\$3,897

LEVEL III .....\$5,751

+ COMMUNITY FEE

A one-time community fee is due at move-in.

ONE-TIME FEE .....\$7,500



Your memory care rental package includes:

- » Studio apartment with private bathroom
- » Basic utilities and internet access
- » Three kosher family-style meals, with snacks and refreshments always available
- » State-of-the-art personal emergency response system
- » Lifestyle and leisure programs
- » Housekeeping, laundry and linen services
- » 24-hour nursing care

**\*Please note:** cable and phone are not included in monthly rental fees.

# RESERVATION FORM

Application Date \_\_\_\_\_

## PERSONAL INFORMATION

☐ Mr. ☐ Dr. ☐ Mrs. ☐ Ms. ☐ Miss ☐ Other \_\_\_\_\_

Last Name \_\_\_\_\_ First Name \_\_\_\_\_ MI \_\_\_\_\_ Date of Birth \_\_\_\_\_

☐ Mr. ☐ Dr. ☐ Mrs. ☐ Ms. ☐ Miss ☐ Other \_\_\_\_\_

Last Name \_\_\_\_\_ First Name \_\_\_\_\_ MI \_\_\_\_\_ Date of Birth \_\_\_\_\_

Address \_\_\_\_\_

City \_\_\_\_\_ State \_\_\_\_\_ Zip \_\_\_\_\_

Home Phone \_\_\_\_\_ Mobile Phone \_\_\_\_\_

Email \_\_\_\_\_ Fax \_\_\_\_\_

## FAMILY MEMBER INFORMATION

Name \_\_\_\_\_ Relationship \_\_\_\_\_

Address \_\_\_\_\_

City \_\_\_\_\_ State \_\_\_\_\_ Zip \_\_\_\_\_

Home Phone \_\_\_\_\_ Mobile Phone \_\_\_\_\_

Email \_\_\_\_\_ Fax \_\_\_\_\_

## FORMALITIES

This application is being managed by: ☐ Prospective Resident ☐ Family/Friend ☐ Other \_\_\_\_\_

Name \_\_\_\_\_ Relationship \_\_\_\_\_

How did you hear about us? \_\_\_\_\_

I understand that returning this signed reservation form and the application fee assures me of a position on the waiting lists I have selected. Applicants will be considered in the order of their position on the lists, which is determined by the date of receipt of this form and fee. The fee is not refundable. Applicants' rights may not be assigned to others, and do not pass to heirs or personal representatives. Reservation will be on file for 6 months.

Future Resident \_\_\_\_\_

Future Resident \_\_\_\_\_

Or By \_\_\_\_\_ Authorized Agent \_\_\_\_\_ Date \_\_\_\_\_